

NOTICE OF AN APPLICATION FOR PLANNING PERMIT

The land affected by the application is located at:	L1 TP654388 25 Main Street, Pakenham
The application is for a permit to:	Development of an office
The applicant for the permit is:	G Holwell
The application reference number is:	T170183
You may look at the application and any documents that support the application at the office of the Responsible Authority:	<p>Cardinia Shire Council 20 Siding Avenue Officer 3809</p> <p>This can be done during office hours and is free of charge.</p> <p>Documents can also be viewed on Council's website www.cardinia.vic.gov.au.</p>

Any person who may be affected by the granting of the permit may object or make other submissions to the responsible authority.

- An objection must
- * be sent to the Responsible Authority in writing, at Cardinia Shire Council, PO Box 7, Pakenham, Vic, 3810 or email at mail@cardinia.vic.gov.au
 - * include the name and address of the objector/ submitter
 - * include the application number and site address
 - * include the reasons for the objection, and
 - * state how the objector would be affected.

The Responsible Authority will not decide on the application before:	2 May 2017
----------------------------------------------------------------------	------------

If you object, the Responsible Authority will advise you of its decision.

Please be aware that copies of objections/submissions received may be made available to any person for the purpose of consideration as part of the planning process.

For additional information or advice contact Cardinia Shire Council, Planning Department on 1300 787 624 or mail@cardinia.vic.gov.au

Your objection/ submission and personal information is collected by Cardinia Shire Council for the purposes of the planning process as set out in the *Planning and Environment Act 1987*. If you do not provide your name and address, Council will not be able to consider your objection/ submission. Your objection/ submission will be available free of charge at the Council office for any person to inspect and copies may be made available on request to any person for the relevant period set out in the *P&E Act*. You must not submit any personal information or copyright material of third parties without their informed consent. By submitting the material, you agree that the use of the material as detailed above does not breach any third party's right to privacy and copyright.

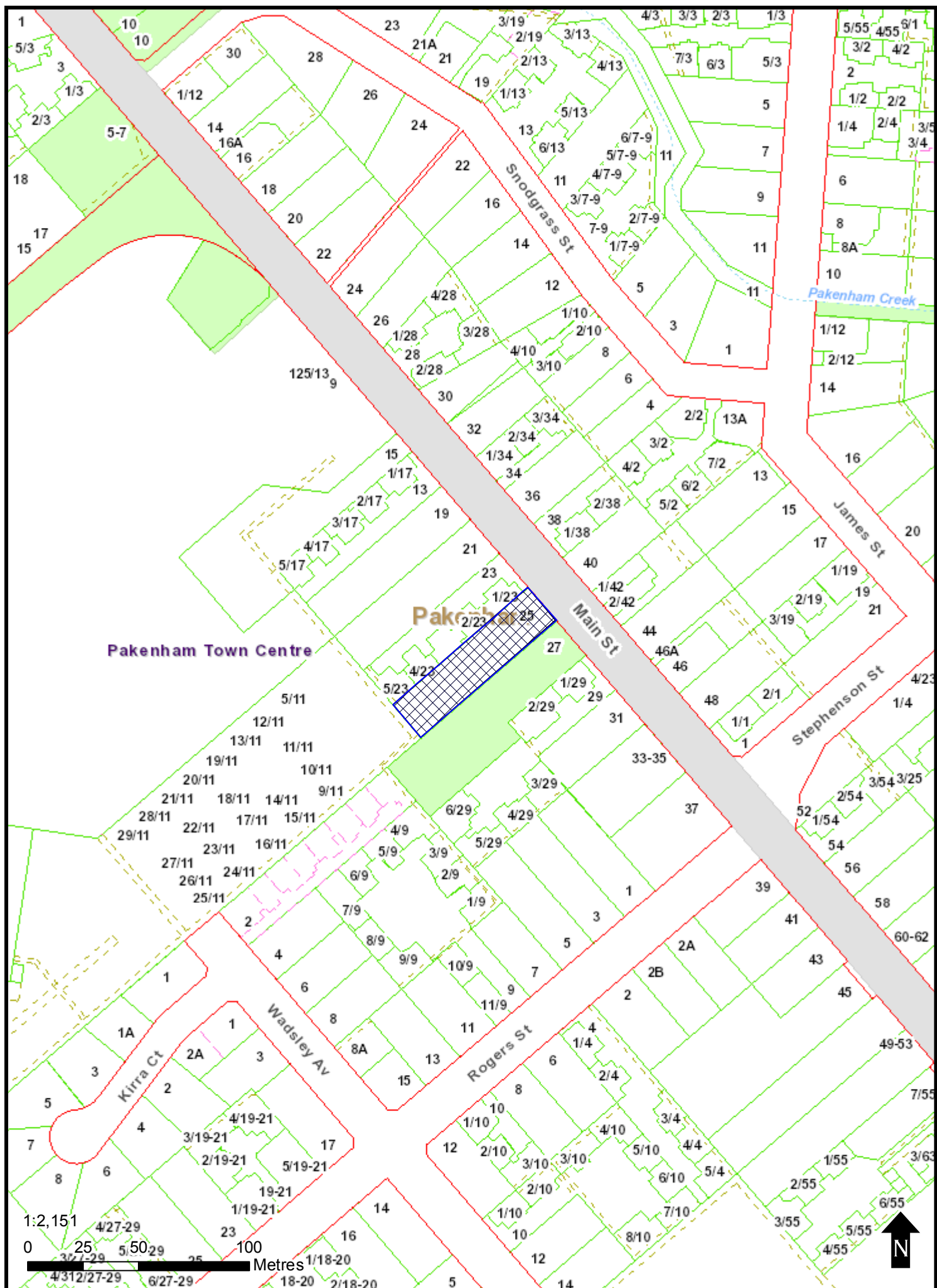

This copied document is made available for the purpose of the planning process as set out in the Planning and Environment Act 1987. The information must not be used for any other purpose. By taking a copy of this document you acknowledge and agree that you will only use the document for the purpose specified above and that any dissemination, distribution or copying of this document is strictly prohibited.



Drawing Schedule

- TP00 DRAWING SCHEDULE
- TP01 SITE CONTEXT & DESIGN RESPONSE
- TP01 SITE PLAN & FLOOR PLAN
- TP01 ELEVATIONS
- TP01 LANDSCAPE PLAN
- TP01 SHADOWS

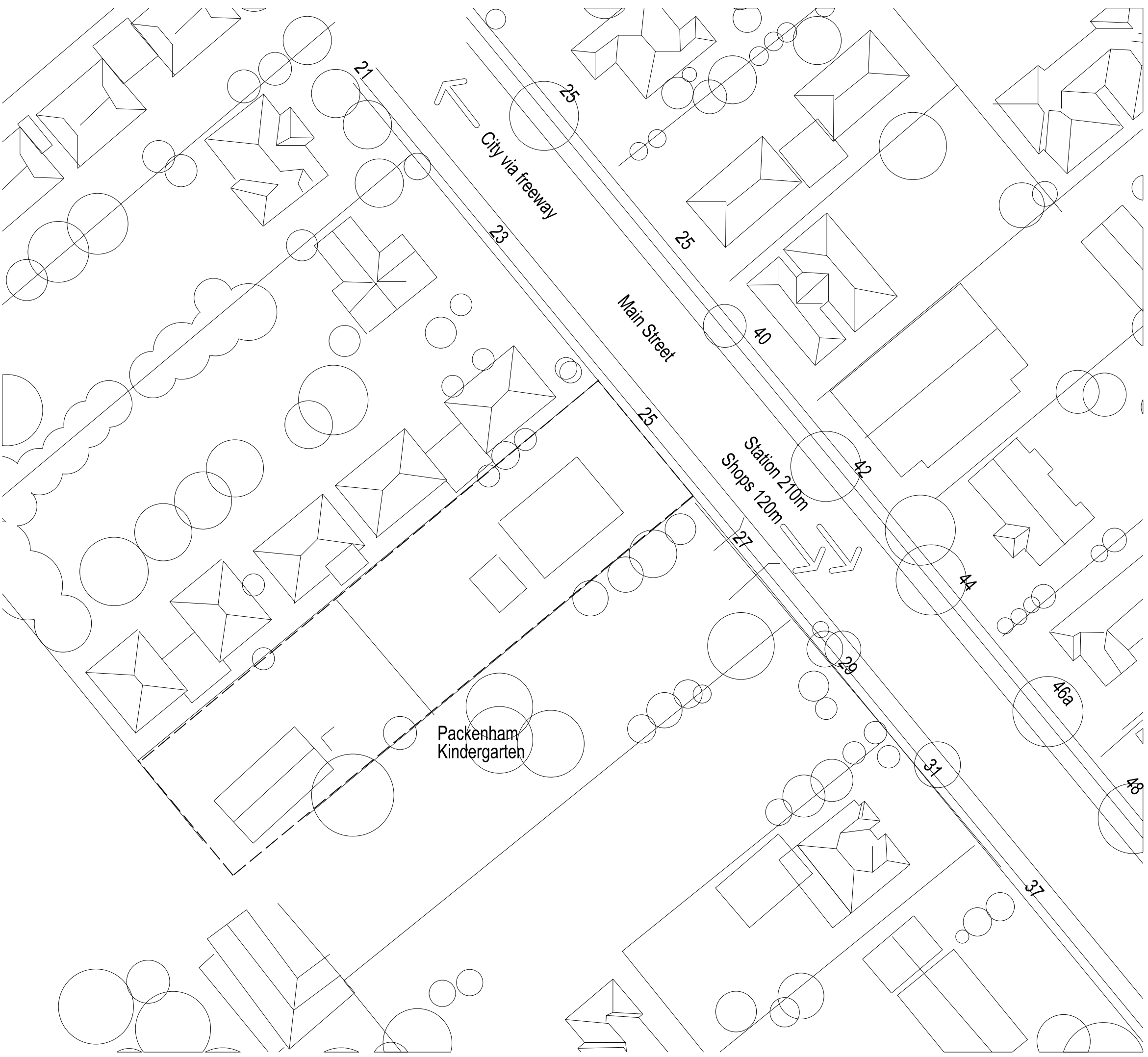

Site Context Plan
Scale 1:500

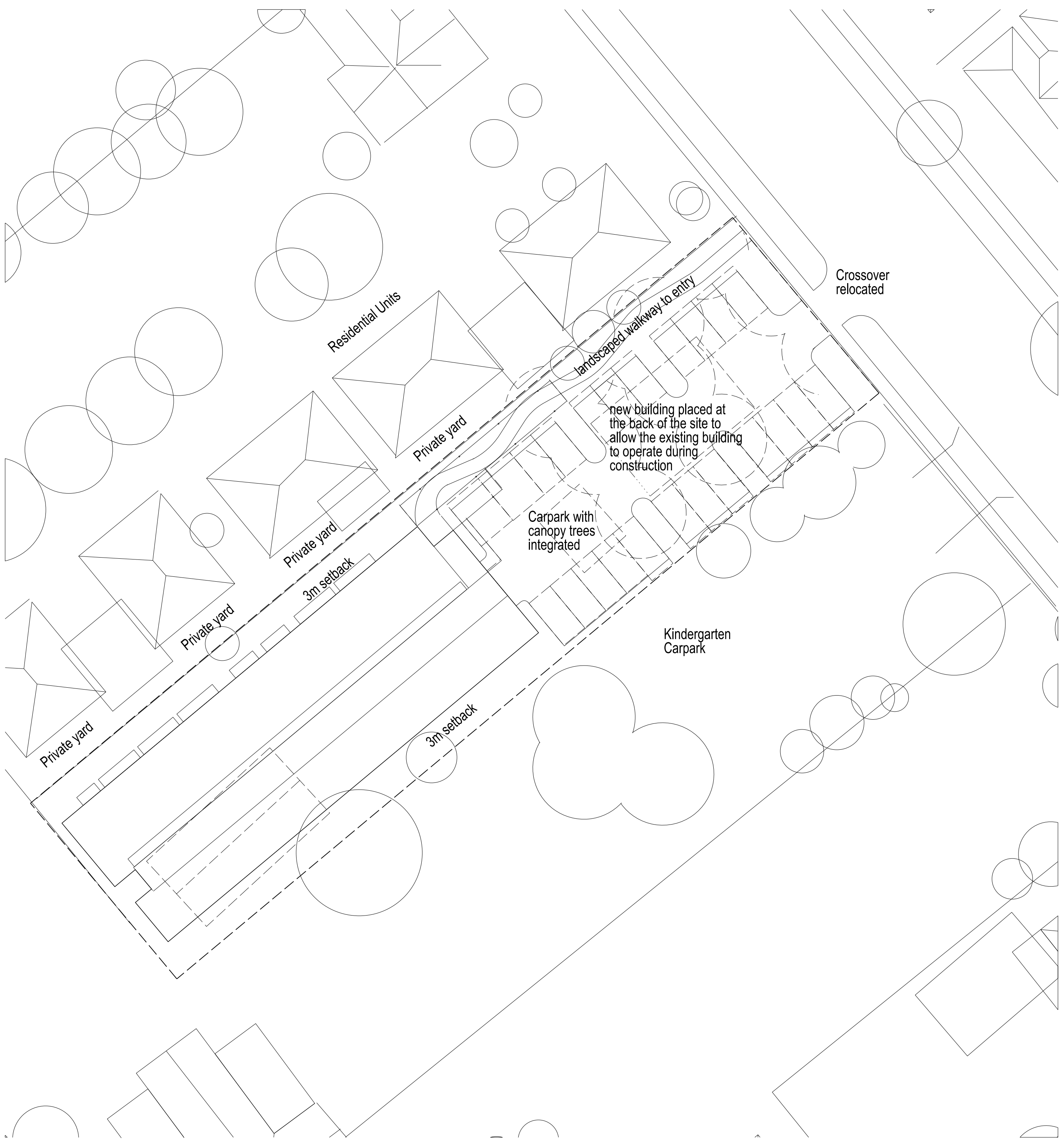

Design Response Plan
Scale 1:200

This copied document is made available for the purpose of the planning process as set out in the Planning and Environment Act 1987. The information must not be used for any other purpose. By taking a copy of this document you acknowledge and agree that you will only use the document for the purpose specified above and that any dissemination, distribution or copying of this document is strictly prohibited.

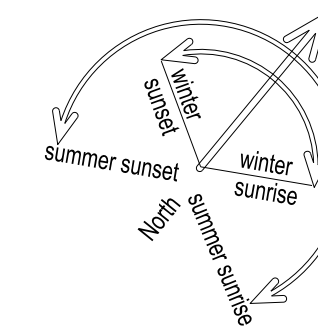
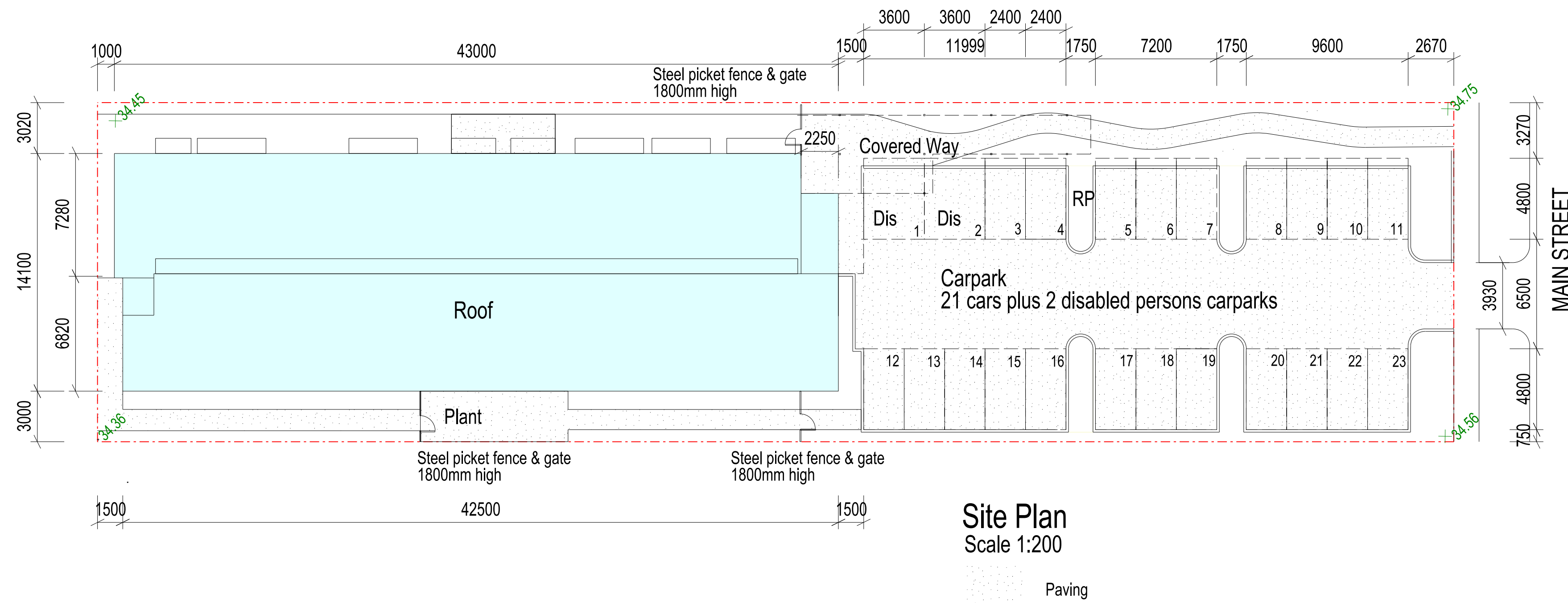

Site area	1,618.99sqm
Gross area of building	589sqm (36% of site)
Carpark area	495.4sqm
Paved area	175.5sqm
Landsaped area	358sqm (22%)

