

## NOTICE OF AN APPLICATION FOR PLANNING PERMIT

The land affected by the application is located at:	Lot 1 LP44970 180 North Yannathan Road, Catani
The application is for a permit to:	Re-subdivision of the land in to three (3) lots (boundary re-alignment)
The applicant for the permit is:	Nobelius Land Surveyors P/L
The application reference number is:	T170018
You may look at the application and any documents that support the application at the office of the Responsible Authority:	Cardinia Shire Council 20 Siding Avenue Officer 3809  This can be done during office hours and is free of charge.  Documents can also be viewed on Council's website <a href="http://www.cardinia.vic.gov.au">www.cardinia.vic.gov.au</a> .

Any person who may be affected by the granting of the permit may object or make other submissions to the responsible authority.

- An objection must
- \* be sent to the Responsible Authority in writing, at Cardinia Shire Council, PO Box 7, Pakenham, Vic, 3810 or email at [mail@cardinia.vic.gov.au](mailto:mail@cardinia.vic.gov.au)
  - \* include the name and address of the objector/ submitter
  - \* include the application number and site address
  - \* include the reasons for the objection, and
  - \* state how the objector would be affected.

The Responsible Authority will not decide on the application before:	13 April 2017
--	---------------

If you object, the Responsible Authority will advise you of its decision.

Please be aware that copies of objections/submissions received may be made available to any person for the purpose of consideration as part of the planning process.

For additional information or advice contact Cardinia Shire Council, Planning Department on 1300 787 624 or [mail@cardinia.vic.gov.au](mailto:mail@cardinia.vic.gov.au)

Your objection/ submission and personal information is collected by Cardinia Shire Council for the purposes of the planning process as set out in the *Planning and Environment Act 1987*. If you do not provide your name and address, Council will not be able to consider your objection/ submission. Your objection/ submission will be available free of charge at the Council office for any person to inspect and copies may be made available on request to any person for the relevant period set out in the *P&E Act*. You must not submit any personal information or copyright material of third parties without their informed consent. By submitting the material, you agree that the use of the material as detailed above does not breach any third party's right to privacy and copyright.

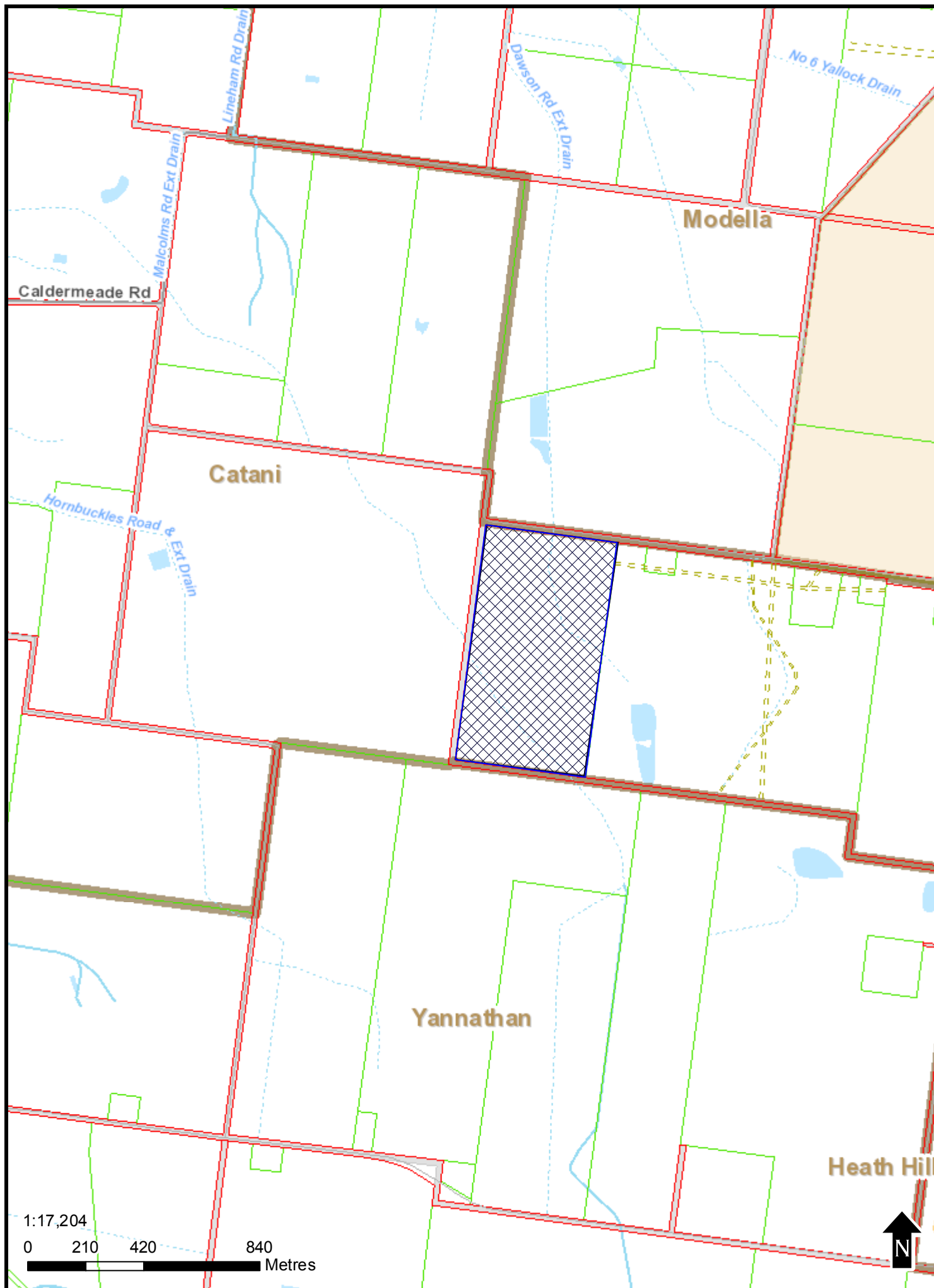

# PLAN OF SUBDIVISION

EDITION 1

# PS 803704 L

## LOCATION OF LAND

PARISH: Yannathan

TOWNSHIP: ---

SECTION: ---

CROWN ALLOTMENT: 59(pt)

CROWN PORTION: ----

TITLE REFERENCE: Vol. 11160 Fol's. 891 & 892, Vol. 8392 Fol. 348

LAST PLAN REFERENCE: Lots 1 & 2 PS 627430 D, Lot 1 LP 44970

POSTAL ADDRESS: 270 North Yannathan Road, Catani 3981  
(at time of subdivision)

MGA CO-ORDINATES: E: 386 300 ZONE: 55  
(of approx centre of land N: 5 770 000 GDA 94  
in plan)

Council Name: Cardinia Shire Council

This copied document is made available for the purpose of the planning process as set out in the Planning and Environment Act 1987. The information must not be used for any other purpose. By taking a copy of this document you acknowledge and agree that you will only use the document for the purpose specified above and that any dissemination, distribution or copying of this document is strictly prohibited.

## VESTING OF ROADS AND/OR RESERVES

## NOTATIONS

IDENTIFIER	COUNCIL/BODY/PERSON	NOTATIONS
Nil	Nil	
NOTATIONS		
DEPTH LIMITATION: DOES NOT APPLY		
<p><b>SURVEY:</b> This plan is based on survey.</p> <p><b>STAGING:</b> This is not a staged subdivision. Planning Permit No.</p> <p>This survey has been connected to permanent marks No(s). In Proclaimed Survey Area No. ---</p> <p>Lot 3 on this plan is not subject to this survey.</p>		

## EASEMENT INFORMATION

LEGEND: A - Appurtenant Easement E - Encumbering Easement R - Encumbering Easement (Road)

Easement Reference	Purpose	Width (Metres)	Origin	Land Benefited/In Favour Of
E-1, E-4 & E-7	Electricity Supply Purposes	See Plan	LP 218653	All lots on LP 218653
E-1, E-2 E-4, E-5 E-6, E-7	Powerlines	See Plan	This Plan	SPI Electricity Pty. Ltd.
E-2	Electricity Supply Purposes	See Plan	LP 218618	All lots on LP 218618
E-3, E-4 & E-6	Drainage	6.70	LP44970	Lots on LP 44970
E-3, E-4 & E-6	Drainage	6.70	E44942	C/T Vol. 6251 Fol. 124

### NOBELIUS LAND SURVEYORS



P.O. BOX 461  
PAKENHAM 3810  
Ph 03 5941 4112  
mail@nobelius.com.au

SURVEYORS FILE REF: 14,948

ORIGINAL SHEET  
SIZE: A3

SHEET 1 OF 2

LICENSED SURVEYOR: R. P. NOBELIUS  
VERSION A

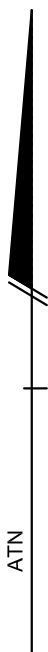
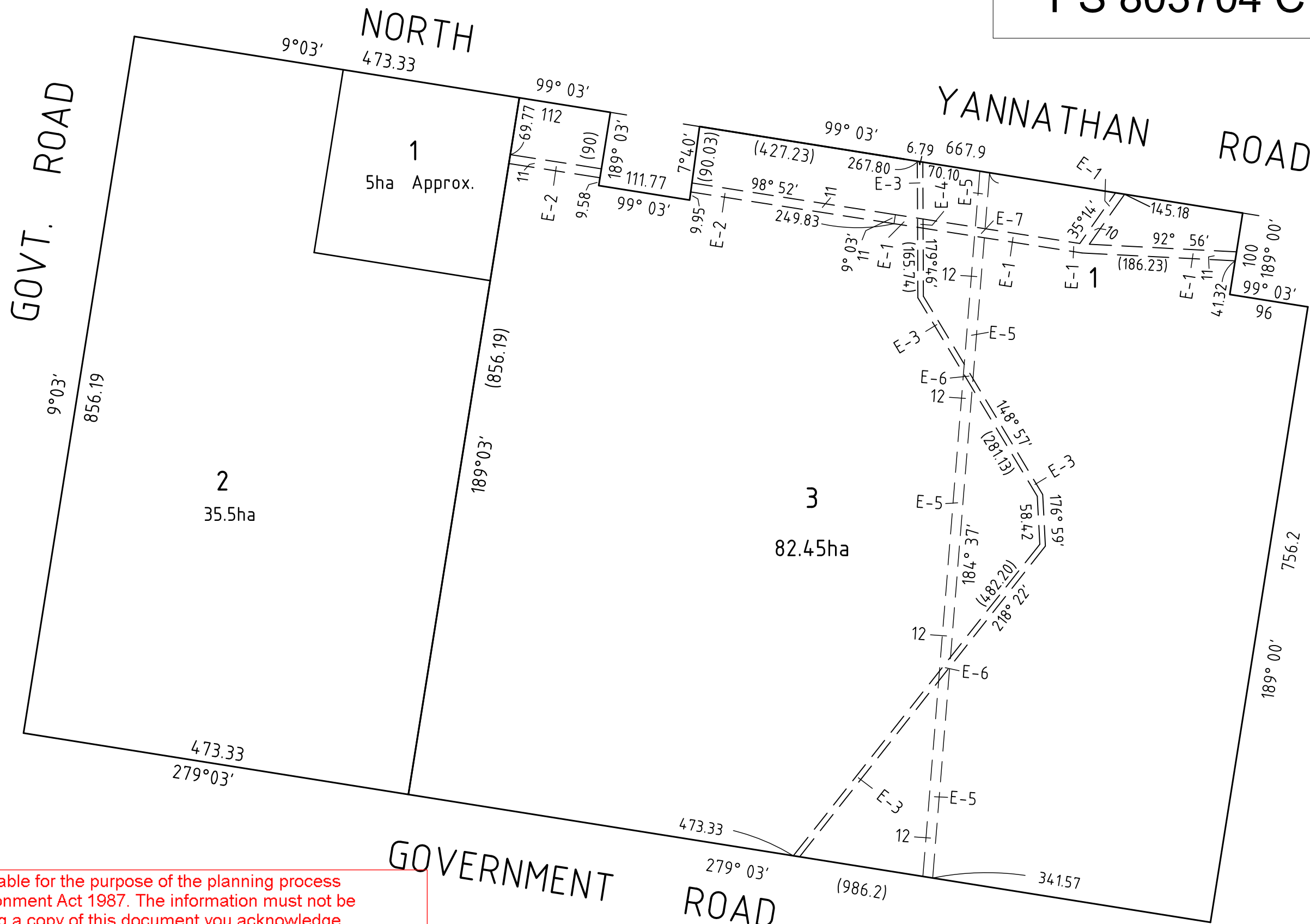

This copied document is made available for the purpose of the planning process as set out in the Planning and Environment Act 1987. The information must not be used for any other purpose. By taking a copy of this document you acknowledge and agree that you will only use the document for the purpose specified above and that any dissemination, distribution or copying of this document is strictly prohibited.

**NOBELIUS LAND SURVEYORS**  
 P.O. BOX 461  
 PAKENHAM 3810  
 Ph 03 5941 4112  
 mail@nobelius.com.au

SCALE  
 1:5000

LENGTHS ARE IN METRES

ORIGINAL SHEET  
 SIZE: A3

SHEET 2

LICENSED SURVEYOR: R. P. NOBELIUS  
 VERSION